

HYTAP™ Type YGHP-C Figure 6 Connector

Irreversible compression ground tap figure 6 can be used as a tap connector or as a tap splice connector. Four die sets and eight connectors can accommodate a conductor range from #8 solid through 500 kcmil plus 1/2", 5/8" and 3/4" copper bonded ground rods. UL467 Listed. Acceptable for direct burial in earth and concrete. Prefilled with PENETROX™ compound and strip sealed.



IEEE-837*

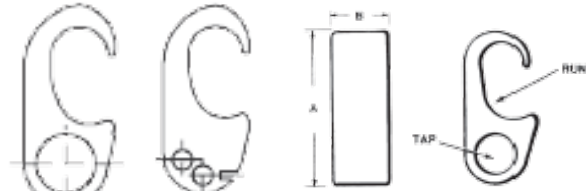

Fig. 1

Fig. 2

✓ UL96 Listed for Lightning Protection.

Dimensions in brackets { } represent lightning protection conductors.

Catalog Number	Fig. #	Accommodates		⑦ Cable to Rebar		B	Die Index	Installation Data			
		Run ⑧	Tap	Run	Tap			750, 35 Series	45 Series ①	46 Series ②	# of Crimps
YGHP2C2	1	#6 Sol. (0.162) {59500} - #2 Str. (0.292) {59500}	④ #6 Sol. (0.162) {59500} - #2 Str. (0.292) {59500}	—	—	0.75	O	UO	UO	UO	1
YGHP2C6W6W ⑤	2	#6 Sol. (0.162) - #2 Str. (0.292)	#8 Sol. (0.128) - #6 Str. (0.184) Qty. 2	—	—						1
YGHP29C6W6W ⑤	2		#8 Sol. (0.128) - #6 Str. (0.184) Qty. 2	#3 Rebar 3/8 - 1/2 #4 Rebar	#8 Sol. - 6 Str.						1
YGHP29C2	1	1/0 Str. (0.372) {98500} - 250 kcmil (0.575) {131500}	#4 Sol. (0.204) {#4 Sol.} - #2 Str. (0.292) {#2 Str.}	#3 Rebar 3/8 - 1/2 #4 Rebar	#4 Sol. - 2 Str.	2.31	997	U997	U997	U997	1
YGHP29C26	1	1/2" - 5/8" Rod	1/0 Str. (0.372) {98500} - 2/0 Str. (0.419) {98500}	#3 Rebar 3/8 - 1/2 #4 Rebar	1/0 Str. - 2/0 Str.						1
YGHP29C29 ⑥	1		3/0 Str. (0.470) {131500} - 250 kcmil (0.575) {211500}	#3 Rebar 3/8 - 1/2 #4 Rebar	3/0 Str. - 250 kcmil						1
YGHP34C2 ③	1	250 kcmil (0.575) {250 kcmil} - 500 kcmil (0.813) {500 kcmil} 5/8" - 3/4" Rod	#4 Sol. (0.204) - #2 Str. (0.292)	#5 Rebar 5/8 - 3/4 #6 Rebar	—	998	PU998	PU998 or S998	PU998 or P998	1	
YGHP34C26 ③	1		1/0 Str. (0.372) {98500} - 2/0 Str. (0.419) {98500}	#5 Rebar 5/8 - 3/4 #6 Rebar	1/0 Str. - 2/0 Str.					1	
YGHP34C29 ③	1		3/0 Str. (0.470) {131500} - 250 kcmil (0.575) {211500}	#5 Rebar 5/8 - 3/4 #6 Rebar	3/0 Str. - 250 kcmil					1	
YGHP34C34 ③	1	250 kcmil (0.575) - 500 kcmil (0.813) 5/8" - 3/4" Rod	350 kcmil (0.681) - 500 kcmil (0.843)	#5 Rebar 5/8 - 3/4 #6 Rebar	350 kcmil - 500 kcmil	2.75	1011	U1011	S1011	P1011	3

NOTES:

- ① 45 Series tools require PT6515 adapter to use "U" or "PU" die
- ② 46 Series tools require PUADP1 adapter to use "U" or "PU" die
- ③ These connectors can only be installed using the 750, 45 or 46 Series tools; cannot be installed with the 35 Series.
- ④ When using #6 Sol in tap, fold conductor double for improved fill.
- ⑤ Not UL96/CSA
- ⑥ When using 3/0 in tap, minimum run conductor must be 2/0 Str.
- ⑦ Clean rust and protective coatings from rebar prior to installation to provide proper ground connection. Precrimping is not required.

*Please contact Customer Service for applications requiring IEEE-837 2014.

Ground Rod ⑧ Dia.	PRECRIMP Dies	
1/2"	UPRECRIMP12	U2CABT
5/8"	UPRECRIMP58	
3/4"	UPRECRIMP34	

③ When attaching connector to ground rod, ground rod must be embossed with appropriate PRECRIMP die. For connectors that must meet IEEE 837 requirements, UPRECRIMP-type precrimp dies must be used for maximum clamping retention. No precrimp needed if using S1012, P1011 or U1011 die sets.

HYTAP™ Type YGHP-C Ground Rod Tap Connector

Type YGHP-C irreversible compression ground tap figure 6 can be used as a ground rod tap connector for both continuous run and tapping applications. An open groove allows ground rod to be connected to a continuous run or tap. The second groove is for a tap only. Prefilled with PENETROX™ E and strip sealed. UL467 Listed for direct burial in earth or concrete. *For applications requiring IEEE-837 2014, please contact Customer Service.

IEEE-837*



Features & Benefits

- Tap A accepts a continuous run or tap conductor; Tap B accepts a tap conductor only; one connector style can be used for many applications reducing the number of connectors required in inventory
- Material is high conductivity wrought copper extrusion, identical material to the conductor, minimizing resistance and voltage drop; additionally eliminates the possibility of corrosion due to dissimilar metals
- System engineered tooling has been designed to ensure a reliable, dependable connection every time
- Die index number is embossed on connector after completion of crimp facilitating inspection of installed connectors and ensures consistently reliable and dependable connections
- Prefilled with PENETROX™ E compound and individually sealed in clear polyethylene sheet ensuring electrical integrity of the finished connection by inhibiting moisture and contaminants from entering the contact area
- UL467 Listed and may be used in direct burial or concrete embedded grounding applications providing quality assurance to recognized industry NEC standard from an independent party
- "Third Hand" constrains conductors while installer completes crimp is included with each connector simplifying installation and reducing installed cost

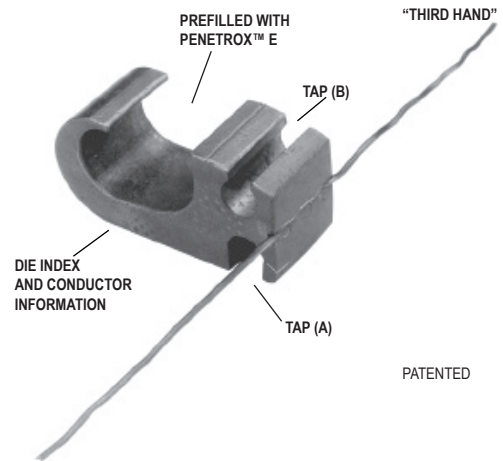

PATENTED

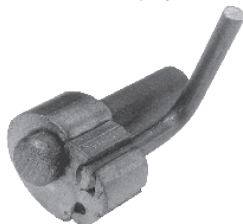
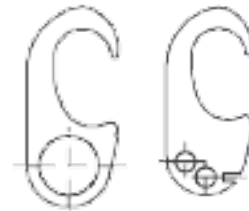
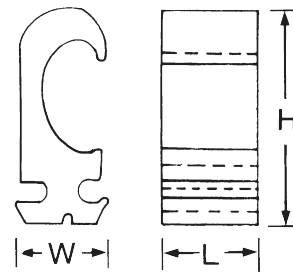

SINGLE TAP

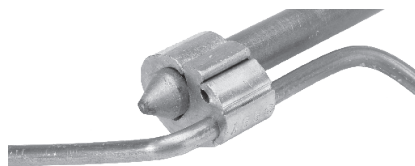

CONTINUOUS RUN

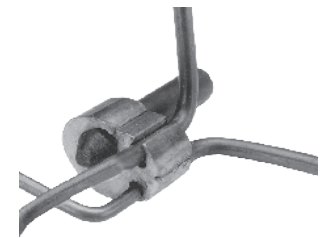

CONTINUOUS RUN AND TAP

Catalog Number	Ground Rod Dia. ①	Tap Conductor ②	Dimensions			Installation Tooling Die Number ③ (# of Crimps)		Die Index
			H	L	W	35, 750 Series	④ 46 Series	
YGHP58C2W-2	1/2" - 5/8"	#2 Sol. - #6 Sol. Copper (1) Continuous Run and (1) Tap or up to (2) Taps may be connected	1.90"	0.75"	0.94"	U997 (1)	U997 (1)	997
YGHP58C2W-2TN								

① Ground rod must be precrimped with die U2CABT (Index 348); for greater rotational resistance use UPRECRIMP die; Galvanized Steel Rods require YGHP58C2W-2TN

② Either tap position may be left void when fewer than (2) conductors are used

③ See Tooling Section in Master Catalog for complete tool and die listing

④ Use PUADP1 adapter when using "U"-dies in 46 Series tools

NOTE:

A 12" bend radius is recommended for the conductor